

 **ADOPEN®**

The image shows a detailed cross-section of a white PVC window profile system. The profile is multi-chambered, with a central red chamber and a lower red chamber. The profile is shown in a corner configuration, with a glass pane visible in the background. The background is dark grey, and there are blue geometric shapes in the corners. The profile is shown in a corner configuration, with a glass pane visible in the background. The background is dark grey, and there are blue geometric shapes in the corners.

W 800 - W 860 SERİSİ
PVC PROFİL SİSTEMLERİ



TEKNİK

W 800 - W 860 SERİSİ

Profil Geniřlięi: 80 mm

Odacık Sayısı: 6 Odacıklı Sistem

Profil Sınıfı: A Class (TS EN 12608-1) / RAL 716-GZ A Class

Conta Sistem: İç-Dış, 2'li conta sistemi

Conta Tipi/Rengi: TPE - Gri / Siyah

Cam Kalınlıkları (mm): 24, 32, 42mm

Isı İletim Katsayısı Uf: 1,2 W/m²K

- 1 6 Odacıklı Kasa.
- 2 Damlalıklı ve Düz Kanat Seçeneęi.
- 3 Çift ve Üçlü Cam Seçeneęi.

AÇIKLAMA

· Ana profilleri 80mm genişliktedir.

· Gri ve siyah renkteki leke bırakmayan elastik contalar sayesinde üst düzeyde hava, su, toz ve ses yalıtımı sağlanır.

· 6 odacıklı profilleri sayesinde ısı ve ses yalıtımında yüksek performans sağlar.

· Yüksek katlı binalarda rüzgar yüküne karşı yüksek mukavemet sağlayan özel tasarım profillere sahip bir seridir.

· Düz kanat profiline ilave olarak damlalıklı kanat profili seçeneęi de sunulmaktadır.

· Beyaz gövde rengine ilave olarak renkli ve lamineli profilleri mevcuttur.

· 24 - 32 - 42 mm kadar çift cam, üçlü cam ve panel kullanımı sağlayan çitaları mevcuttur.

RENK SEÇENEKLERİ

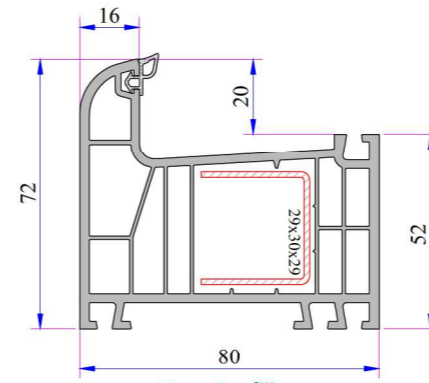

Kasa Profili
Kod: P.A.860.1000.600.0.BC.01

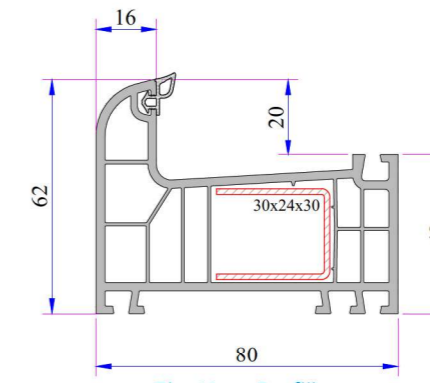

Eko Kasa Profili
Kod: P.A.860.1003.600.0.BC.01

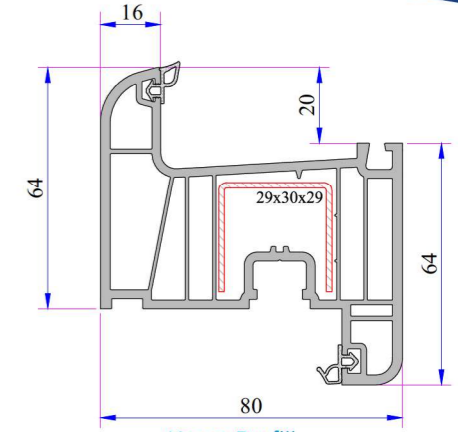

Kanat Profili
Kod: P.A.860.2000.600.0.BC.01

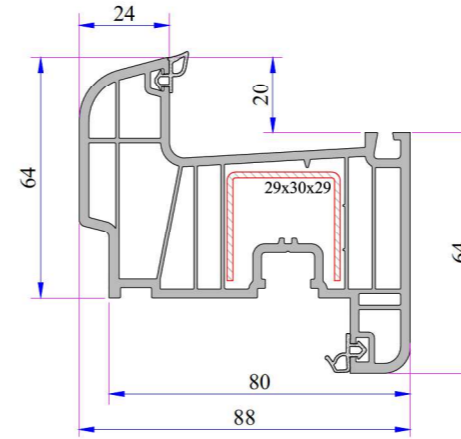

Damlalıklı Kanat Profili
Kod: P.A.860.2200.600.0.BC.01

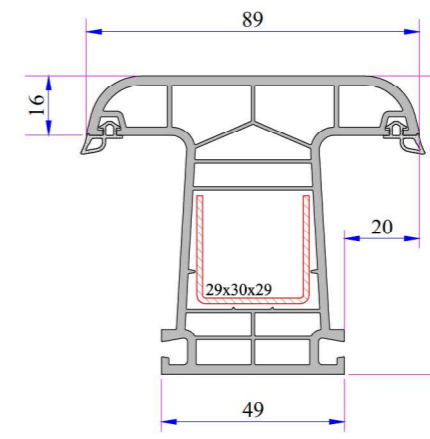

Orta Kayıt Profili
Kod: P.A.860.3000.600.0.BC.01

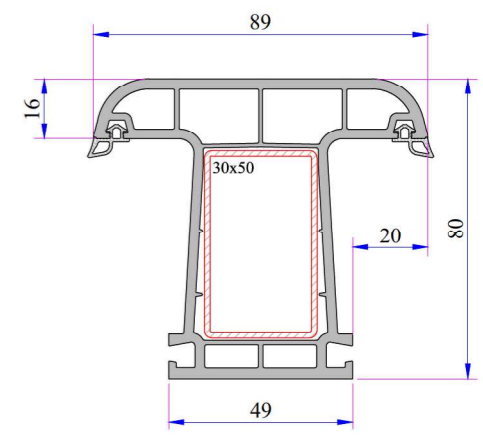

Statik Orta Kayıt Profili
Kod: P.A.800.3009.600.0.BC.01

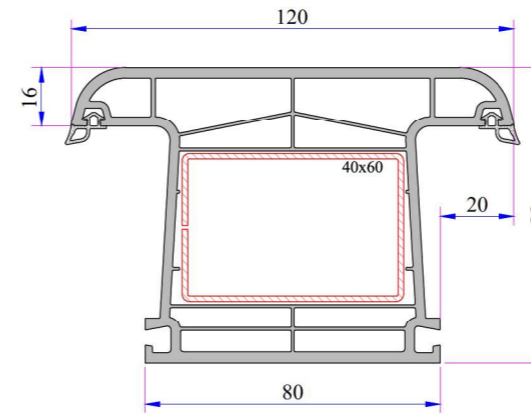

Süper Statik Orta Kayıt Profili
Kod: P.A.800.3008.600.0.BC.01

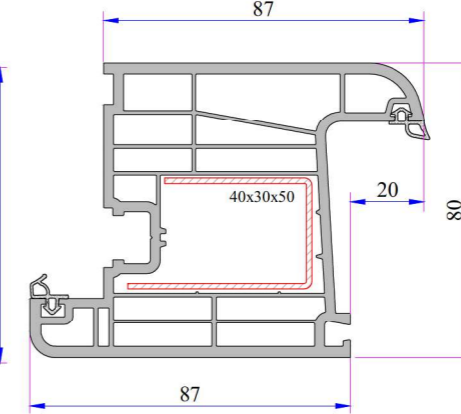

Kapı Kanat Profili
Kod: P.A.800.2100.600.0.BC.01

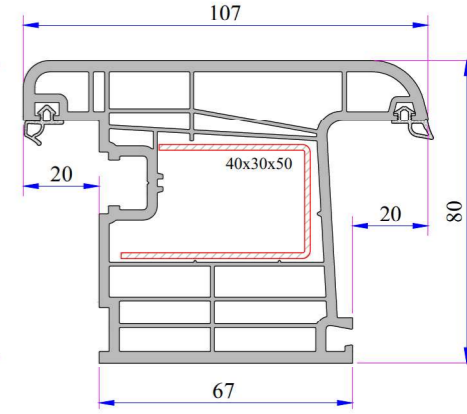

Dışa Açılım Kapı Kanat Profili
Kod: P.A.800.2101.600.0.BC.01

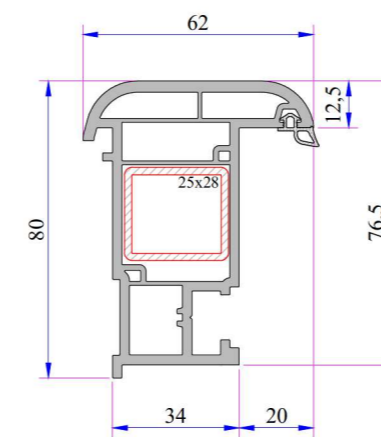

Hareketli Orta Kayıt Profili
Kod: P.A.800.3100.600.0.BC.19

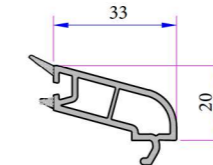

24mm Contalı Çift Cam Çıtası
Kod: P.A.800.4200.600.0.HC

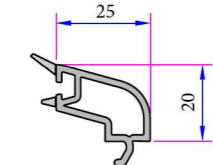

32mm Contalı Üçlü Cam Çıtası
Kod: P.A.800.4500.600.0.HC

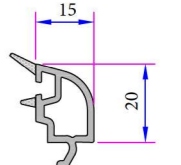

42mm Contalı Üçlü Cam Çıtası
Kod: P.A.800.4600.600.0.HC

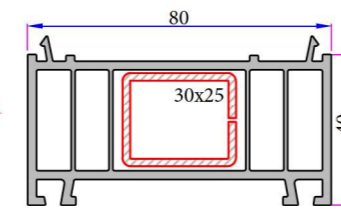

Kasa Yükseltme Profili
Kod: P.A.080.5300.600.0.00.19

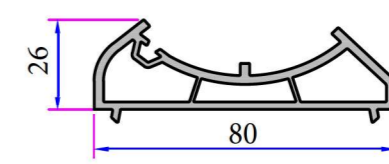

Açılı Köşe Dönüş Adaptörü
Kod: P.A.080.5104.600.0.00.19

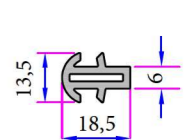

Kısa Bağ Profili
Kod: P.A.099.5003.600

W 800 - W 860 SERİ PVC PROFİL SİSTEMİ

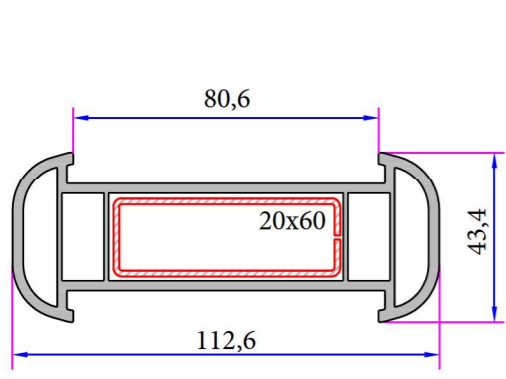

Kalın Bağ Profili
Kod: P.A.080.5000.600.0.00.19

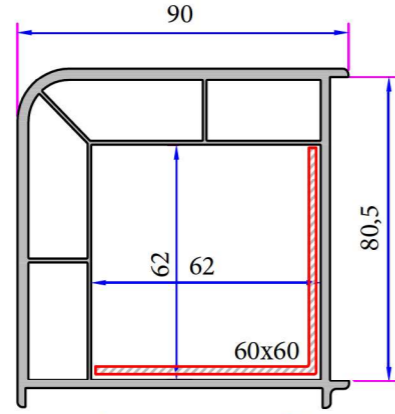

90° Köşe Dönüş Profili
Kod: P.A.080.5100.600.0.00.19

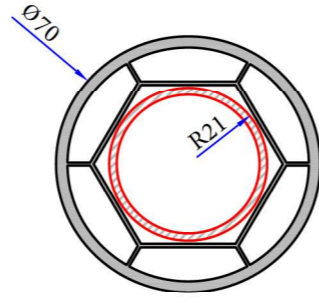

Açılı Köşe Dönüş Borusu Ø70
Kod: P.A.070.5106.600

W 800 - W 860 SERİ PVC PROFİL SİSTEMİ

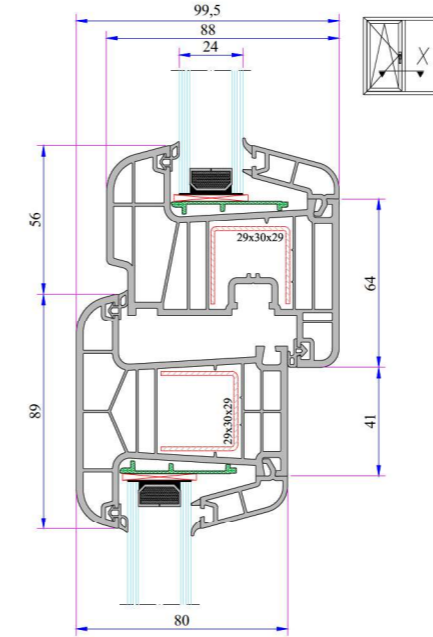

Kanat - Orta Kayıt Montajı

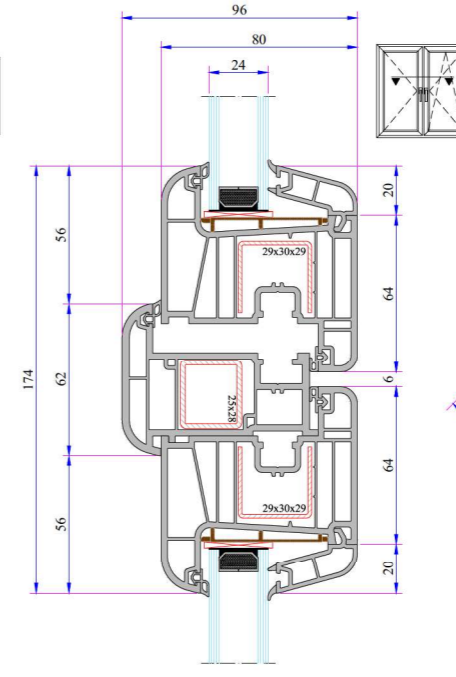

Kanat - Hareketli Orta Kayıt Montajı

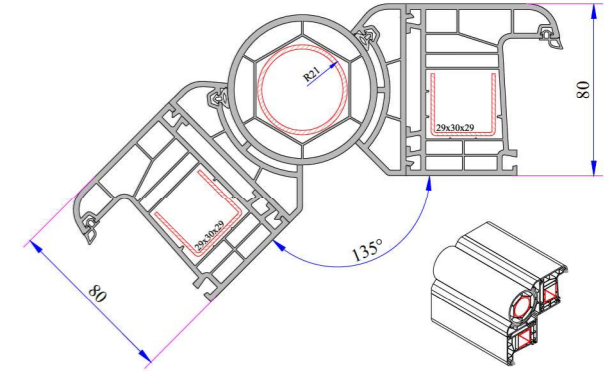

Açılı Köşe Dönüş Borusu Montajı

W 800 W 860 Destek Sacı Profilleri

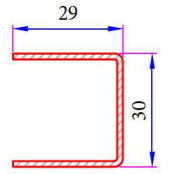

Kasa, Kanat, Orta Kayıt Destek Sacı
Kod: 34022-12002

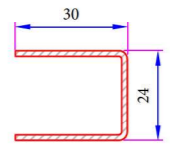

Eko Kasa Destek Sacı
Kod: 34022-12004

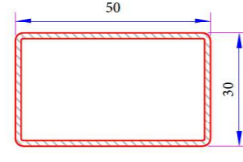

Statik Orta Kayıt Destek Sacı
Kod: 34022-12111

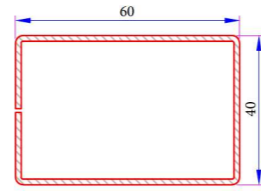

Super Statik Orta Kayıt Destek Sacı
Kod: 34022-12110

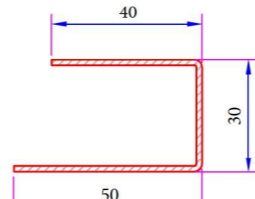

Kapı Kanat-Dışa Açılım Kapı Kanat Destek Sacı
Kod: 34022-12014

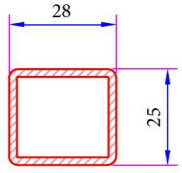

Hareketli Orta Kayıt Destek Sacı
Kod: 34022-12117

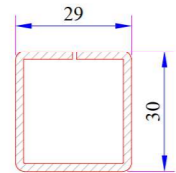

Kasa - Orta Kayıt Statik Destek Sacı
Kod: 34022-15129

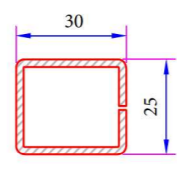

Kasa Yükseltme Destek Sacı
Kod: 34022-12119

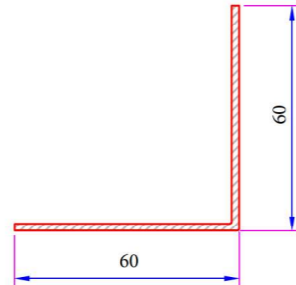

90° Köşe Dönüş Profili Destek Sacı
Kod: 34022-12306

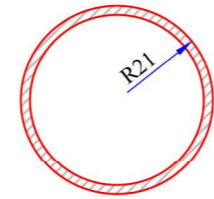

Açılı Köşe Dönüş Borusu Destek Sacı
Kod: 34022-12502

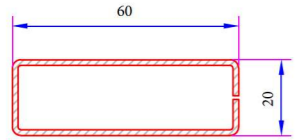

Kalın Bağ Profili Destek Sacı
Kod: 34022-12106

W 800 W 860 Montajlar

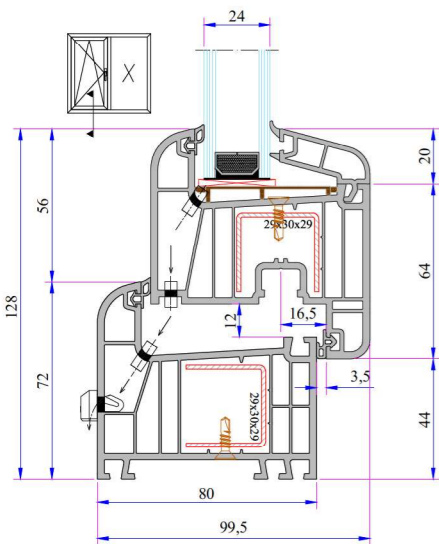

Kasa - Kanat Montajı

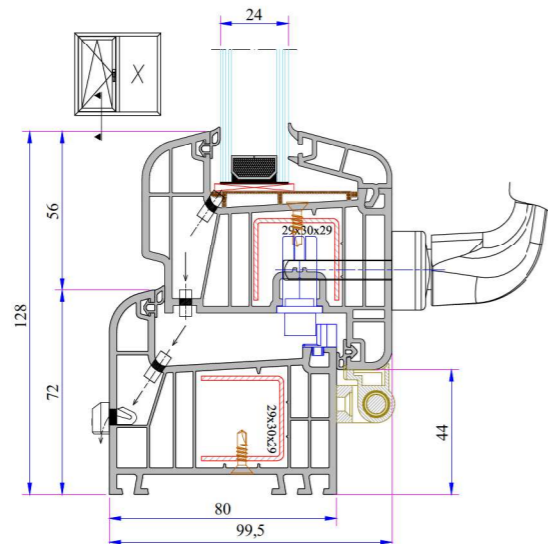

Kasa - Damlalıklı Kanat Montajı

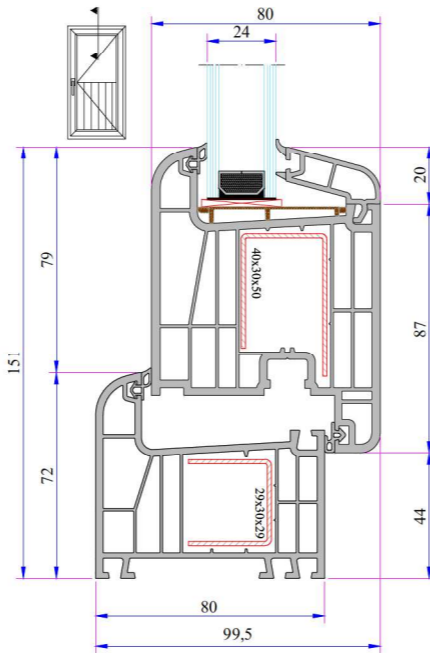

Kasa - Kapı Kanat Montajı

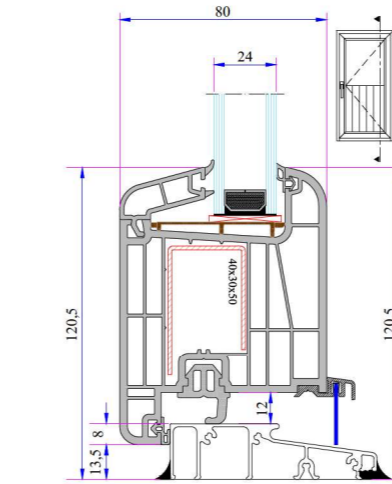

Alüminyum Eşikli Kapı Kanat Montajı

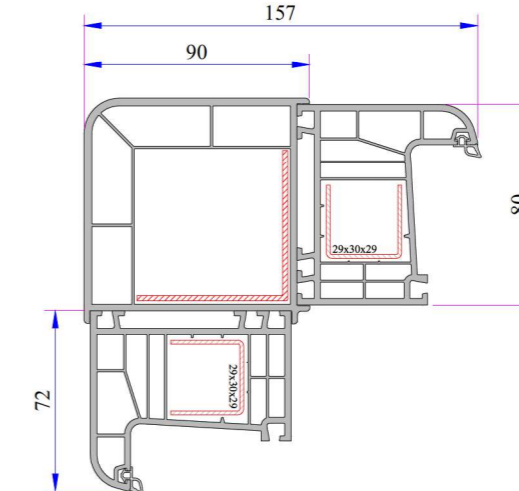

90° Köşe Dönüş Profili Montajı

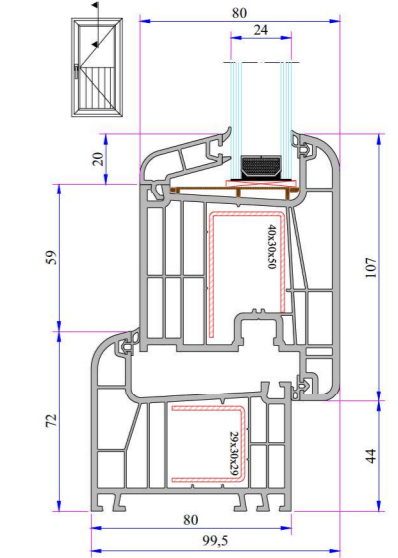

Kasa - Dışa Açılım Kapı Kanat Montajı

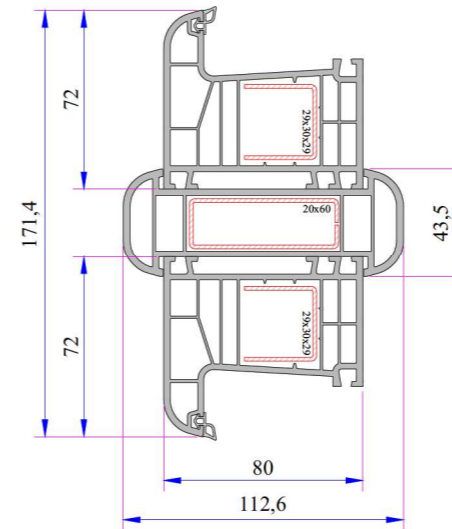

Kalın Bağ Profili Montajı

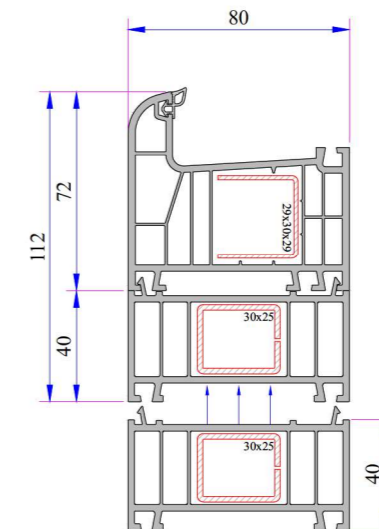

Kasa Yükseltme Profili Montajı

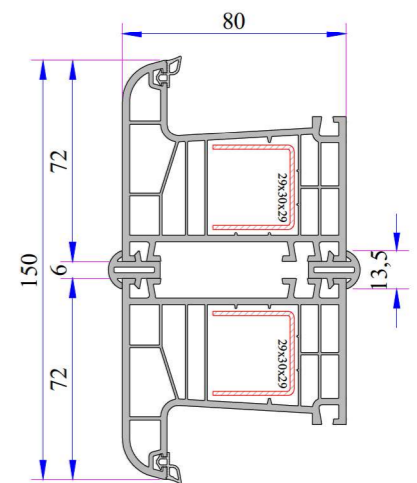

Kısa Bağ Profili Montajı

Project name:	800-860 SERİE	ADOPEN
Transmittance (Uf):	1.2000 W/m ² K	Internal T: 20.00 °C
Conductance (Lf2D):	0.2927 W/mK	External T: 0.00 °C
Frame length (Bf):	128.00 mm	

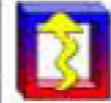

Frame
Simulator 2

Thermal transmittance (Uf) computation performed in accordance with EN ISO 10077-2:2012

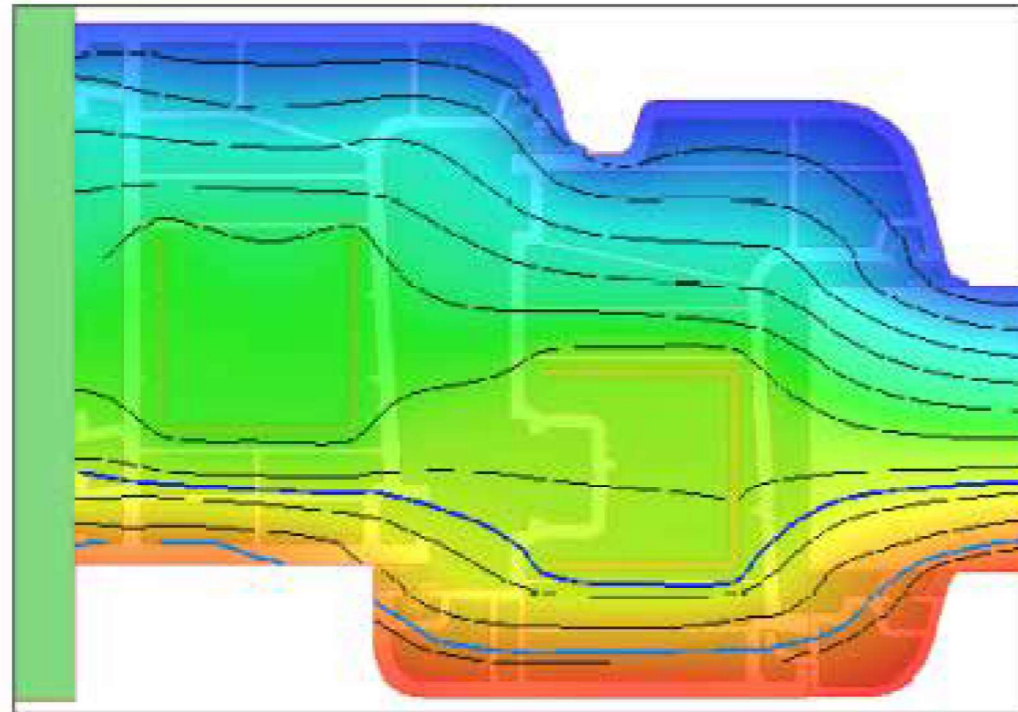

0.29 18.10

Node details

Primitives used for finite element simulation:	19831
Frame width (Bf):	128.00 mm
Visible insulation panel width (Bp):	190.55 mm
Insulation panel thickness (Dp):	46.20 mm

External boundary conditions:

Temperature:	0.00 °C
Surface resistance:	0.040 m ² K/W

Internal boundary conditions:

Temperature:	20.00 °C
Surface resistance:	0.130 m ² K/W
Humidity:	-

Results computed in accordance with EN ISO 10077-2:2012

Internal/external temperature difference:	-
2D conductance (Lf2D):	0.2927 W/mK
Transmittance (Uf):	1.2000 W/m ² K

 **ADOPEN**[®]
www.adopen.com.tr

FACTORY

Antalya Organize Sanayi Bölgesi 2.Kısım Mah. 21.Cadde No:3
07040 Döşemealtı / ANTALYA / TURKEY
Tel : +90 242 236 20 00 · Faks : +90 242 236 20 90 · Email : info@ado.com.tr

