

750 -752 SERIE PVC PROFILE SYSTEM

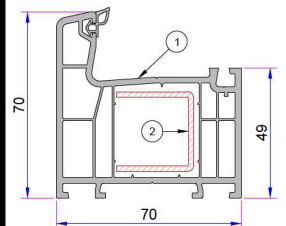

1. Super Frame Profile
P.A.750.1001.600.0.BC.01
2. Reinforcement (29x30x29)
1,2mm - 34022 - 12002
1,5mm - 34022 - 15002
2 mm - 34022 - 20002

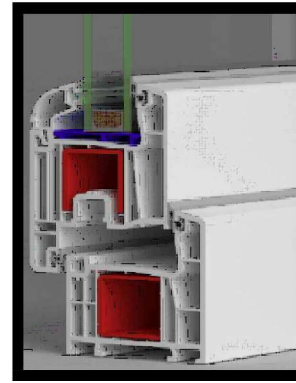
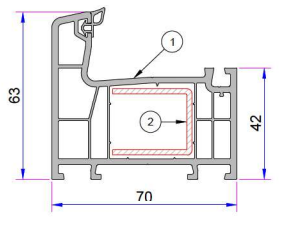

1. Frame Profile
P.A.750.1000.600.0.BC.01
2. Reinforcement (30x25x30)
1,2mm - 34022 - 12004
1,5mm - 34022 - 15004
2 mm - 34022 - 20004

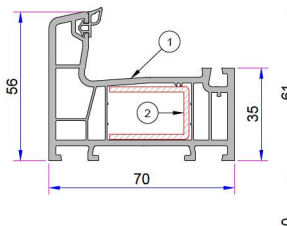

1. Eko Frame Profile
P.A.750.1003.600.0.BC.01
2. Reinforcement (30x20x30)
1,2mm - 34022 - 12006
1,5mm - 34022 - 15006
2 mm - 34022 - 20006

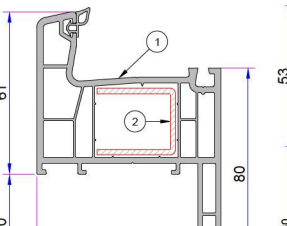

1. Frame Profile with Sill
P.A.750.1200.600.0.BC.01
2. Reinforcement (30x25x30)
1,2mm - 34022 - 12004
1,5mm - 34022 - 15004
2 mm - 34022 - 20004

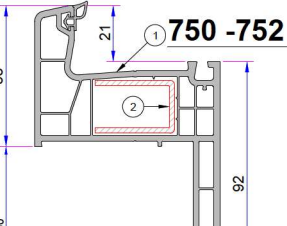

1. Frame Profile with 60mm Sill
P.A.750.1919
2. Reinforcement (30x20x30)
1,2mm - 34022 - 12006
1,5mm - 34022 - 15006
2 mm - 34022 - 20006

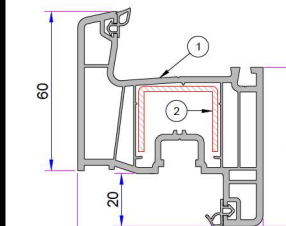

1. Sash Profile
P.A.750.2000.600.0.BC.01
2. Reinforcement (25x30x25)
1,2mm - 34022 - 12025
1,5mm - 34022 - 15025
2 mm - 34022 - 20025

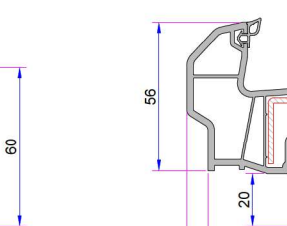

1. Offset Type Sash Profile
P.A.750.2200.600.0.BC.01
2. Reinforcement (25x30x25)
1,2mm - 34022 - 12025
1,5mm - 34022 - 15025
2 mm - 34022 - 20025

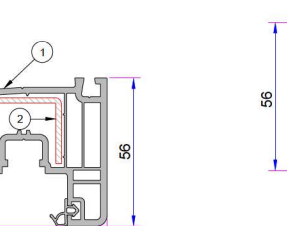

1. Offset Type Sash Profile (6 Chambered)
P.A.750.2205.600.0.BC.01
2. Reinforcement (25x30x25)
1,2mm - 34022 - 12025
1,5mm - 34022 - 15025
2 mm - 34022 - 20025

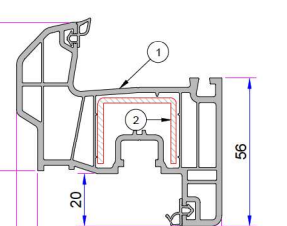

1. 24 Axis Sash Profile
P.A.750.2003.600.0.BC.01
2. Reinforcement (23x30x23)
1,2mm - 34022 - 12030
1,5mm - 34022 - 15030
2 mm - 34022 - 20030

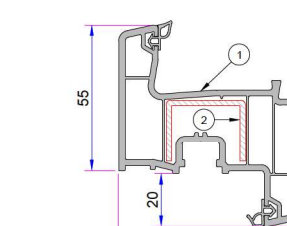

1. Outward Opening Sash Profile
P.A.750.2001.600.0.BC.01
2. Reinforcement (25x25x25)
1,2mm - 34022 - 12003
1,5mm - 34022 - 15003
2 mm - 34022 - 20003

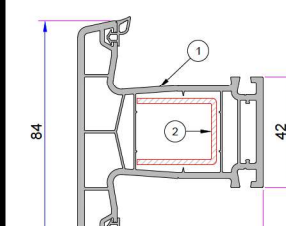

1. Mullion Profile
P.A.750.3000.600.0.BC.01
2. Reinforcement (30x25x30)
1,2mm - 34022 - 12004
1,5mm - 34022 - 15004
2 mm - 34022 - 20004

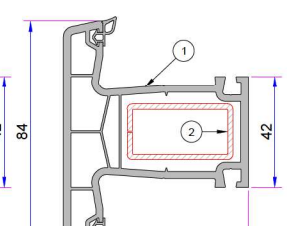

1. Static Mullion Profile
P.A.750.3007.600.0.BC.01
2. Reinforcement (40x20)
1,2mm - 34022 - 12114
1,5mm - 34022 - 15114
2 mm - 34022 - 20114

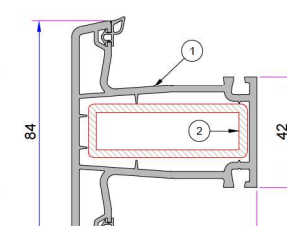

1. Super Static Mullion Profile
P.A.750.3009.600.0.BC.01
2. Reinforcement (60x20)
1,2mm - 34022 - 12106
1,5mm - 34022 - 15106
2 mm - 34022 - 20106

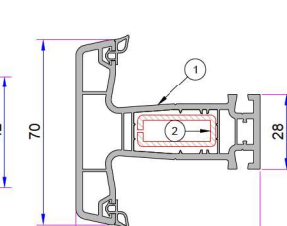

1. Eco Mullion Profile
P.A.750.3006.600.0.BC.01
2. Reinforcement (26x30)
1,2mm - 34022 - 12115
1,5mm - 34022 - 15115
2 mm - 34022 - 20115

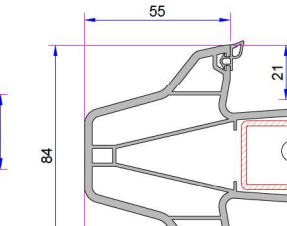

1. 790 Mullion Profile
P.A.790.3000.600.0.BC.01
2. Reinforcement (26x35)
1,2mm - 34022 - 12116
1,5mm - 34022 - 15116
2 mm - 34022 - 20116

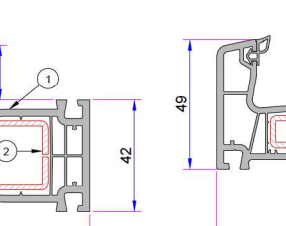

1. Outward Opening Mullion Profile
P.A.750.3005.600.0.BC.01
2. Reinforcement (12x30)
1,2mm - 34022 - 12115
1,5mm - 34022 - 15115
2 mm - 34022 - 20115

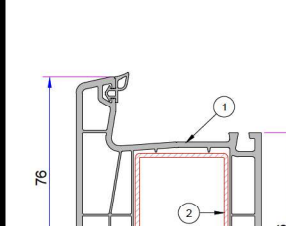

1. Narrow Door Sash Profile
P.A.750.2111.600.0.BC.01
2. Reinforcement (40x35x40x8)
1,2mm - 34022 - 12013
1,5mm - 34022 - 15013
2 mm - 34022 - 20013

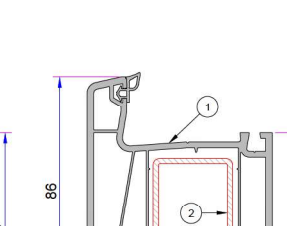

1. Door Sash Profile
P.A.750.2100.600.0.BC.01
2. Reinforcement (50x30x50)
1,2mm - 34022 - 12013
1,5mm - 34022 - 15013
2 mm - 34022 - 20013

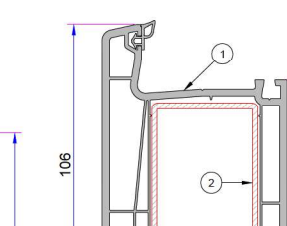

1. Super Door Sash Profile
P.A.750.2103.600.0.BC.01
2. Reinforcement (60x40)
1,2mm - 34022 - 12110
1,5mm - 34022 - 15110
2 mm - 34022 - 20110

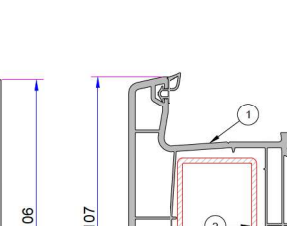

1. Outward Opening Door Sash Profile
P.A.750.2101.600.0.BC.01
2. Reinforcement (50x30x50)
1,2mm - 34022 - 12013
1,5mm - 34022 - 15013
2 mm - 34022 - 20013

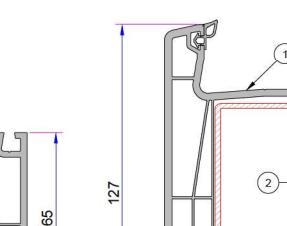

1. Outward Opening Super Door Sash Profile
P.A.750.2104.600.0.BC.01
2. Reinforcement (60x40)
1,2mm - 34022 - 12110
1,5mm - 34022 - 15110
2 mm - 34022 - 20110

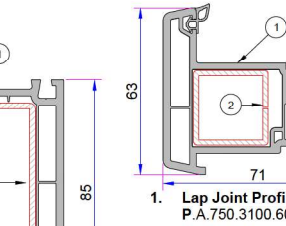

1. Lap Joint Profile
P.A.750.3100.600.0.BC.01
2. Reinforcement (28x28)
1,2mm - 34022 - 12113
1,5mm - 34022 - 15113
2 mm - 34022 - 20113

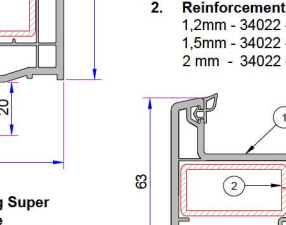

1. Static Lap Joint Profile
P.A.750.3101.600.0.BC.01
2. Reinforcement (40x20)
1,2mm - 34022 - 12114
1,5mm - 34022 - 15114
2 mm - 34022 - 20114

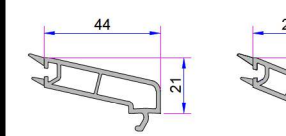

4-6mm Single Glazing Bead
P.A.750.4000.600.0.HC

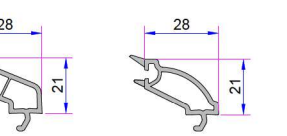

20mm Double Glazing Bead
P.A.750.4100.600.0.HC

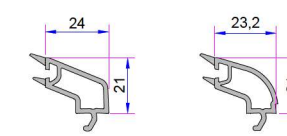

20mm Double Glazing Bead
P.A.750.4102.600.0.HC

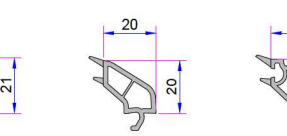

24mm Double Glazing Bead
P.A.750.4200.600.0.HC

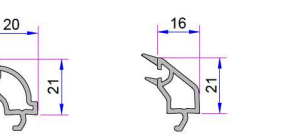

24mm Double Glazing Bead
P.A.750.4204.600.0.HC

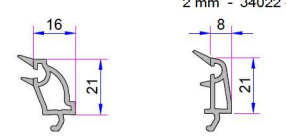

28mm Double Glazing Bead
P.A.101.4100.600.0.HC

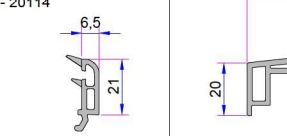

28mm Double Glazing Bead
P.A.101.4102.600.0.HC

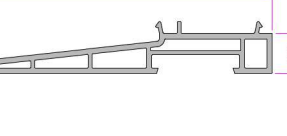

32mm Triple Glazing Bead
P.A.750.4500.600.0.HC

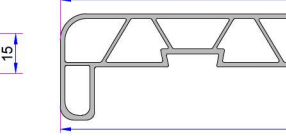

32mm Triple Glazing Bead
P.A.101.4202.600.0.HC

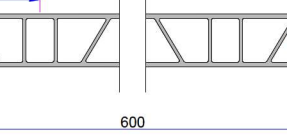

40mm Triple Glazing Bead
P.A.532.4400.600.0.HC

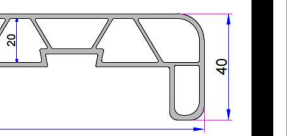

42mm Triple Glazing Bead
P.A.532.4500.600.0.HC

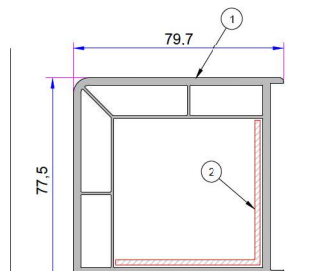

1. 90° Corner Profile
P.A.070.5100.600.0.00.19
2. Reinforcement (55x55)
1,2mm - 34022 - 12305
1,5mm - 34022 - 15305
2 mm - 34022 - 20305

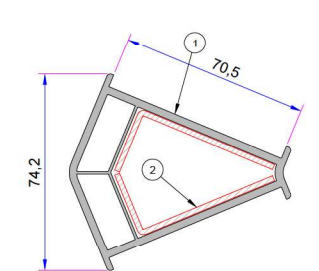

1. 135° Corner Profile
P.A.070.5102.600.0.00.19
2. Reinforcement (25x55)
1,2mm - 34022 - 12303
1,5mm - 34022 - 15303
2 mm - 34022 - 20303

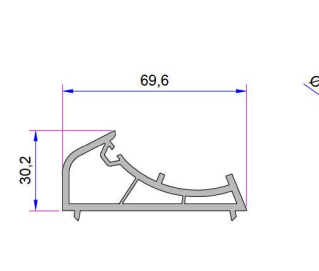

Angled Pipe Profile Adaptor
P.A.070.5104.600.0.00.19

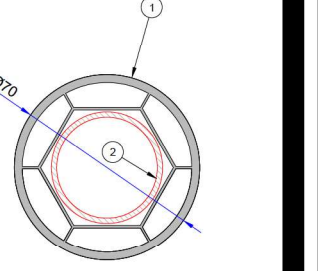

1. Angled Pipe Profile
P.A.070.5106.600.0.00.19
2. Reinforcement (Ø42mm)
1,2mm - 34022 - 12502
1,5mm - 34022 - 15502
2 mm - 34022 - 20502

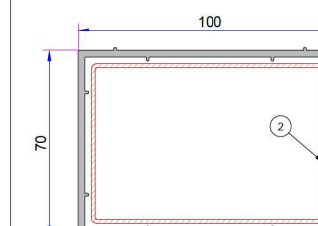

1. Box Profile (70x100)
P.A.070.5202.600.0.00.19
2. Reinforcement (60x90)
1,2mm - 34022 - 12121
1,5mm - 34022 - 15121
2 mm - 34022 - 20121

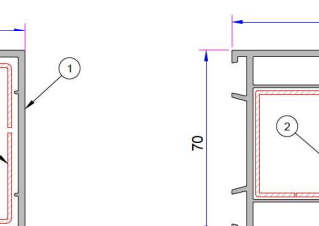

1. 100mm Frame Lifting Profile
P.A.070.5302.600.0.00.19
2. Reinforcement (30x40)
1,2mm - 34022 - 12120
1,5mm - 34022 - 15120
2 mm - 34022 - 20120

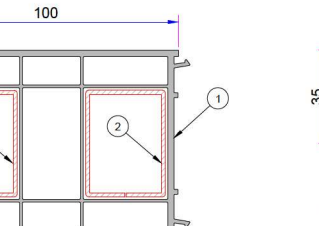

1. 35mm Frame Lifting Profile
P.A.070.5300.600.0.00.19
2. Reinforcement (20x25)
1,2mm - 34022 - 12104
1,5mm - 34022 - 15104
2 mm - 34022 - 20104

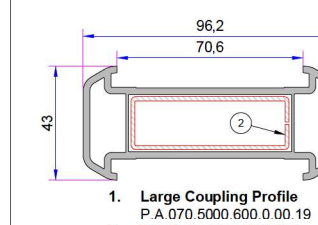

1. Large Coupling Profile
P.A.070.5000.600.0.00.19
2. Reinforcement (20x60)
1,2mm - 34022 - 12106
1,5mm - 34022 - 15106
2 mm - 34022 - 20106

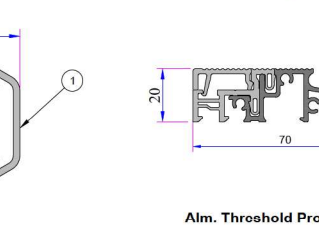

Alm. Threshold Profile
AD16-089

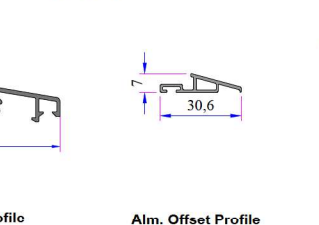

Alm. Offset Profile
AD16-086

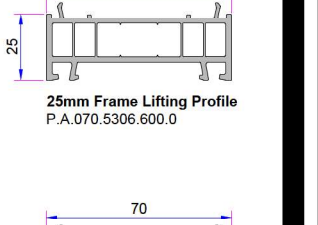

25mm Frame Lifting Profile
P.A.070.5306.600.0

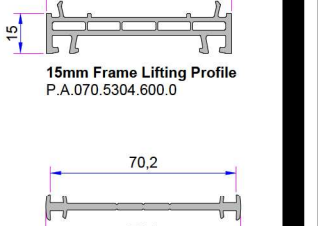

15mm Frame Lifting Profile
P.A.070.5304.600.0

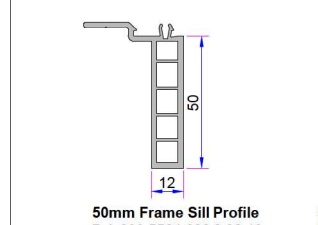

50mm Frame Sill Profile
P.A.099.5524.600.0.00.19

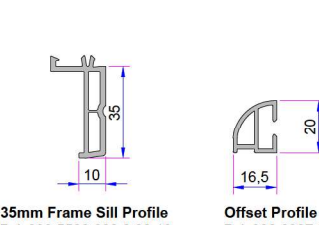

35mm Frame Sill Profile
P.A.099.5523.600.0.00.19

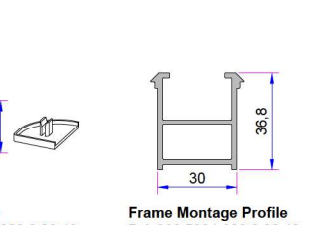

Offset Profile
P.A.900.6307.600.0.00.19

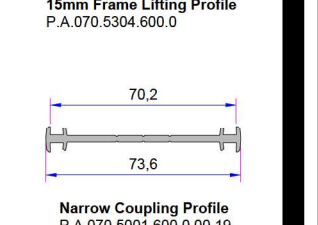

Frame Montage Profile
P.A.060.5301.600.0.00.19

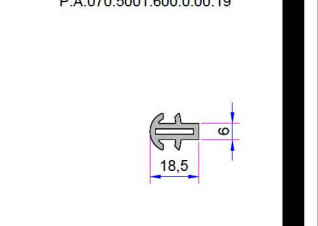

Narrow Coupling Profile
P.A.070.5001.600.0.00.19

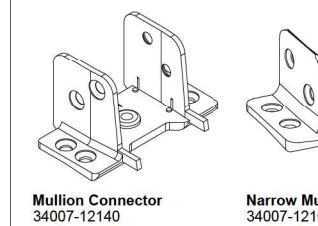

Mullion Connector
34007-12140

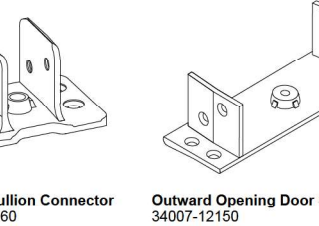

Narrow Mullion Connector
34007-12160

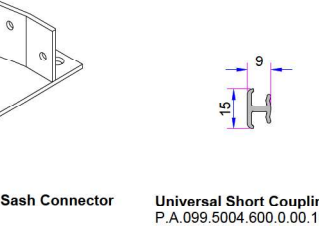

Outward Opening Door Sash Connector
34007-12150

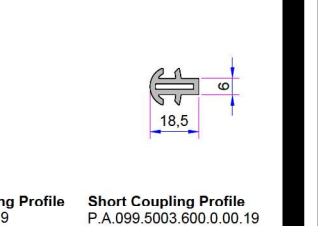

Universal Short Coupling Profile
P.A.099.5004.600.0.00.19

Short Coupling Profile
P.A.099.5003.600.0.00.19

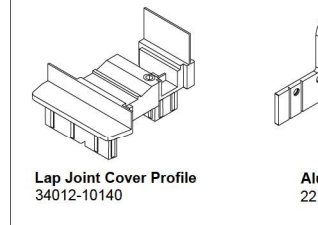

Lap Joint Cover Profile
34012-10140

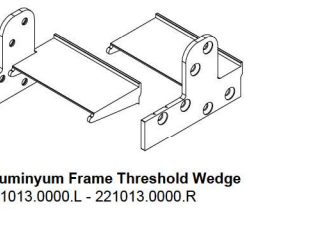

Aluminium Frame Threshold Wedge
221013.0000.L - 221013.0000.R

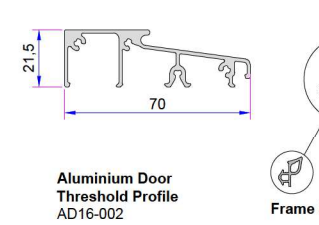

Aluminium Door Threshold Profile
AD16-002

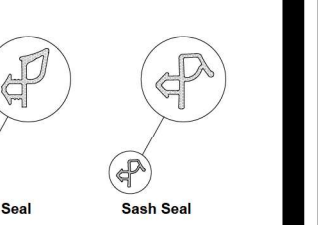

Frame Seal

Sash Seal

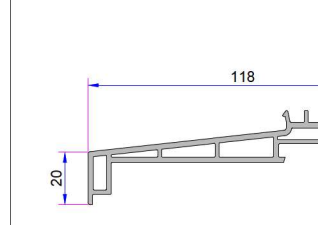

Sill Profile
P.A.058.5504.600.0.00.19

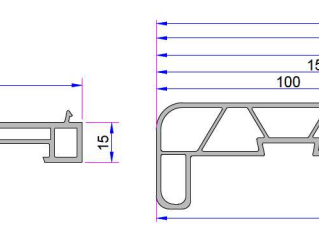

PVC Sill Profile (600mm)
P.DNZ.01.60.E.600.19