

## 232 SLIDING SERIE PVC PROFILE SYSTEM

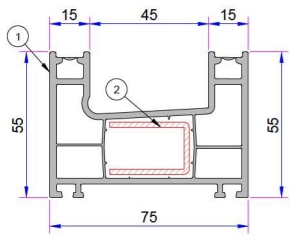

1. Frame Profile (Double Rail)  
P.A.232.1106.600.0.00.01
2. Reinforcement (30x20x30)  
1,2mm - 34022 - 12006  
1,5mm - 34022 - 15006  
2 mm - 34022 - 20006

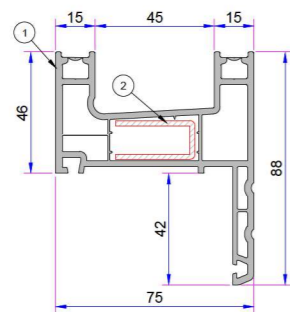

1. Frame Profile (Decorative Sill)  
P.A.232.1107.600.0.00.01
2. Reinforcement (30x15x30)  
1,2mm - 34022 - 12034  
1,5mm - 34022 - 15034  
2 mm - 34022 - 20034

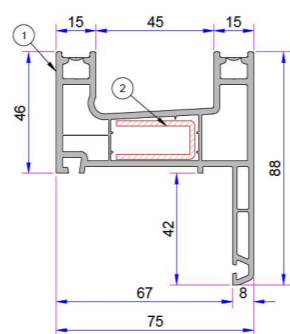

1. Frame Profile (With Sill)  
P.A.232.1110.600.0.00.01
2. Reinforcement (30x15x30)  
1,2mm - 34022 - 12034  
1,5mm - 34022 - 15034  
2 mm - 34022 - 20034

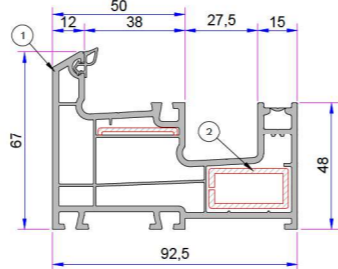

1. Single Rail Frame Profile  
P.A.232.1105.600.0.00.01
2. Reinforcement (30x15)  
1,2mm - 34022 - 12135  
1,5mm - 34022 - 15125  
2 mm - 34022 - 20125

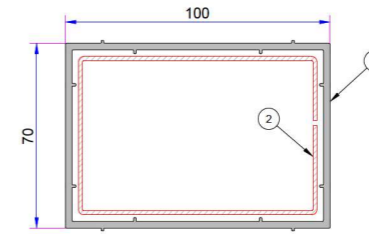

1. Box Profile (70x100)  
P.A.070.5202.600.0.00.19
2. Reinforcement (60x90)  
1,2mm - 34022 - 12121  
1,5mm - 34022 - 15121  
2 mm - 34022 - 20121

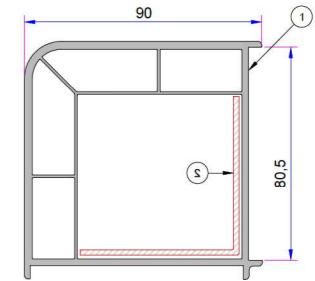

1. 90° Corner Profile  
P.A.080.5100.600.0.00.19
2. Reinforcement (60x60)  
1,2mm - 34022 - 12306  
1,5mm - 34022 - 15306  
2 mm - 34022 - 20306

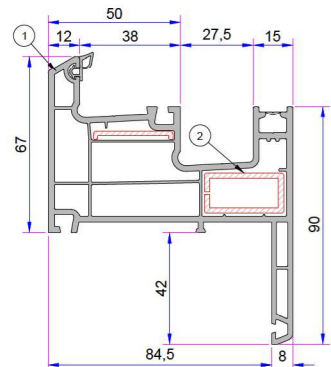

1. Single Rail Sliding Frame (With Sill)  
P.A.232.1114.600.0.00.01
2. Reinforcement (30x15)  
1,2mm - 34022 - 12135  
1,5mm - 34022 - 15135  
2 mm - 34022 - 20135

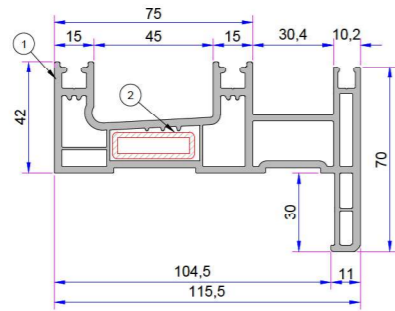

1. Frame Profile With Internal Fly-Screen  
P.A.242.1109.600.0.00.01
2. Reinforcement (30x10)  
1,2mm - 34022 - 12107  
1,5mm - 34022 - 15107  
2 mm - 34022 - 20107

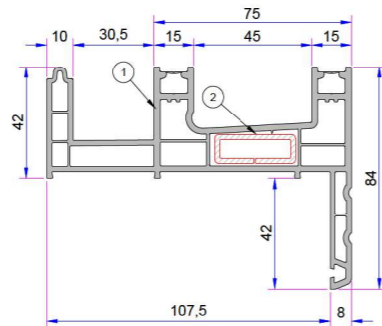

1. Frame Profile With Fly - Screen & Sill  
P.A.232.1109.600.0.00.01
2. Reinforcement (30x11)  
1,2mm - 34022 - 12107  
1,5mm - 34022 - 15107  
2 mm - 34022 - 20107

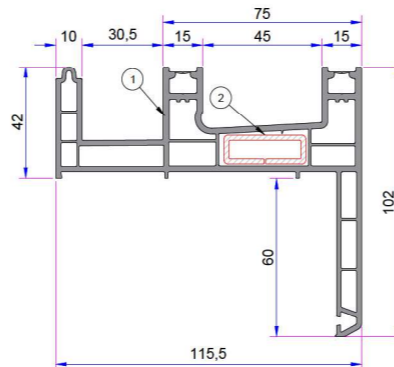

1. Double Rail Frame Profile With Fly - Screen 60 mm Sill  
P.A.232.1115.600.0.00.01
2. Reinforcement (30x11)  
1,2mm - 34022 - 12107  
1,5mm - 34022 - 15107  
2 mm - 34022 - 20107

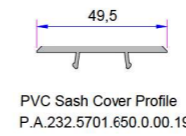
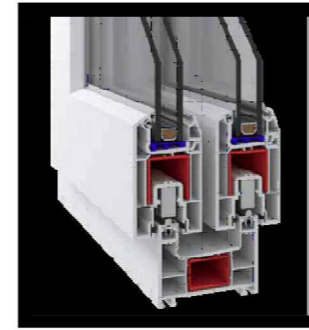

PVC Sash Cover Profile  
P.A.232.5701.650.0.00.19

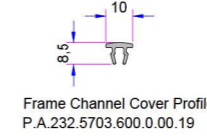

Frame Channel Cover Profile  
P.A.232.5703.600.0.00.19

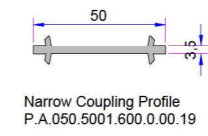

Narrow Coupling Profile  
P.A.050.5001.600.0.00.19

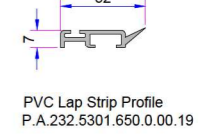

PVC Lap Strip Profile  
P.A.232.5301.650.0.00.19

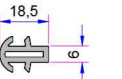

Short Coupling Profile  
P.A.099.5003.600

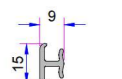

Universal Short Coupling Profile  
P.A.099.5004.600.0.00.19

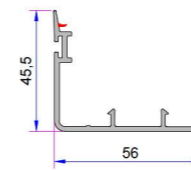

PVC Sash Cover Profile  
P.A.232.5709.600.0.00.01

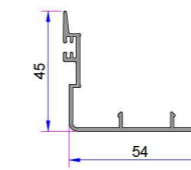

Alm. Sash Cover Profile  
16051.601.5.1.1.9016

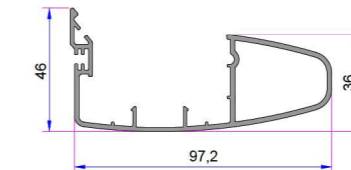

Alm. Sash Cover Grillage Profile  
16028.601.5.2.0.9016



Alm. Decorative Sash Cover Grillage Profile  
AD16061

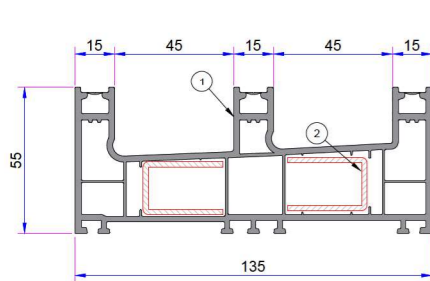

1. Triple Rail Frame Profile  
P.A.232.1112.600.0.00.01
2. Reinforcement (30x20x30)  
1,2mm - 34022 - 12006  
1,5mm - 34022 - 15006  
2 mm - 34022 - 20006

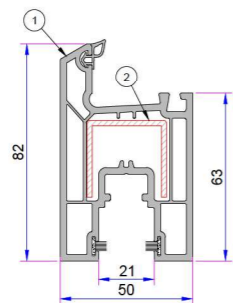

1. Sliding Sash Profile  
P.A.232.2300.600.0.00.01
2. Reinforcement (29x30x29)  
1,2mm - 34022 - 12002  
1,5mm - 34022 - 15002  
2 mm - 34022 - 20002

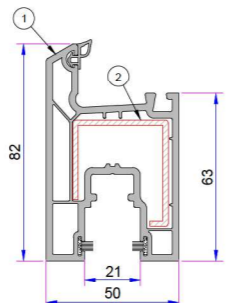

1. Statik Sliding Sash Profile  
P.A.232.2308.600.0.00.01
2. Reinforcement (30x36x40x7)  
1,2mm - 34022 - 12036  
1,5mm - 34022 - 15036  
2 mm - 34022 - 20036

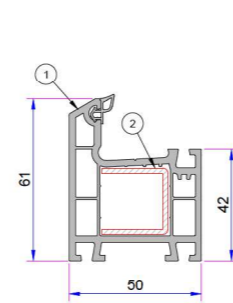

1. 332 Frame Profile  
P.A.332.1000.600.0.00.01
2. Reinforcement (25x25x25)  
1,2mm - 34022 - 12003  
1,5mm - 34022 - 15003  
2 mm - 34022 - 20003

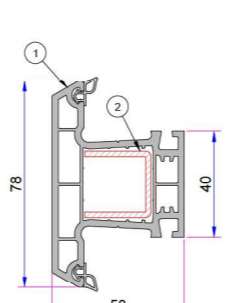

1. 332 Mullion Profile  
P.A.332.3000.600.0.00.01
2. Reinforcement (25x25x25)  
1,2mm - 34022 - 12003  
1,5mm - 34022 - 15003  
2 mm - 34022 - 20003

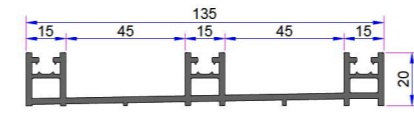

Alm. Triple Rail Threshold  
AD16-035

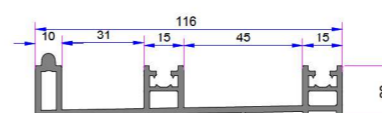

Alm. double Rail Threshold  
AD 16 - 034

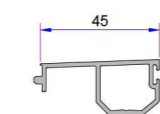

PVC Cover Profile  
P.A.232.5710.600.0.00.19

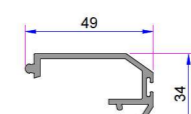

Alm. Cover Profile  
AD 16 - 013

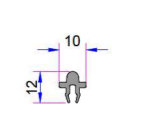

Aluminium Sliding Rail Profile  
AD16-014 PRES

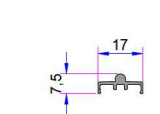

Aluminium Sliding Rail Profile  
AD-16-053

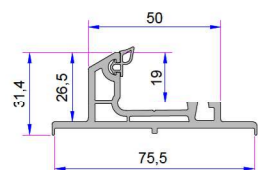

Double Rail Adaptor Profile  
P.A.232.5800.600.0.00.19

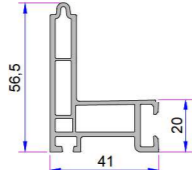

Screen Adaptor Profile  
P.A.232.5802.600.0.00.19

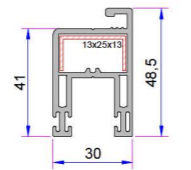

Fly-Screen Sash Profile  
P.A.242.2305.600.0.00.01

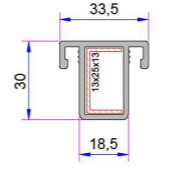

Fly-Screen Mullion Profile  
P.A.242.3200.600.0.00.01

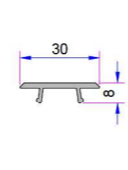

Fly-Screen Sash Cover  
P.A.242.5701.600

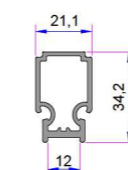

Alm. Double Rail Adaptor Profile  
AD16011

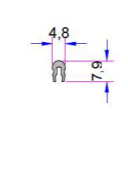

Grillage Cover Profile  
AD16062

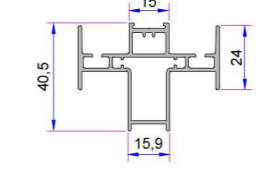

With Alum. Lug Double Sash Middle Adaptor  
AD16058

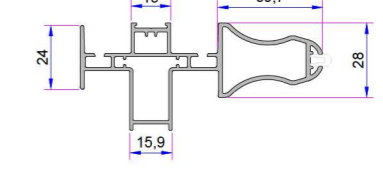

With Alum. Grillage Double Sash Middle Adaptor  
AD16059

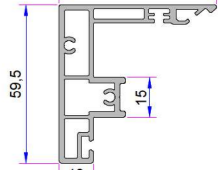

Alum. Sliding Mullion with Three Chambered  
AD16060

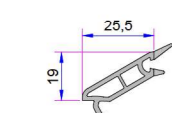

Single Glazing Bead (4 mm)  
P.A.332.4000.600.0.00.01

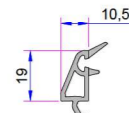

Double Glazing Bead (20 mm)  
P.A.332.4100.600.0.00.01

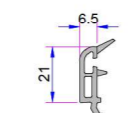

Double Glazing Bead (24 mm)  
P.A.532.4500.600.0.00.01

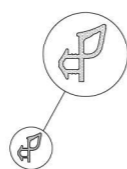

Frame Seal

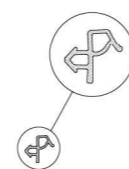

Sash Seal

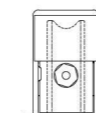

Sliding Roller  
34009 - 18030

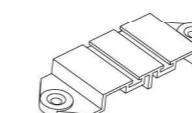

Sealing Bit Single Rail  
34009 - 26010

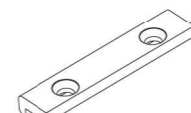

Upper Bedding Piece For Sliding Rail  
34009 - 36010

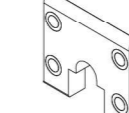

Sliding Sash End Bit  
34009 - 46010



232 Mullion Connector  
34007 - 14030



332 Mullion Connector  
34007 - 11080

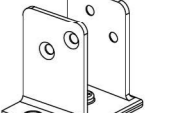

Frame - Frame Connector  
34007-14020