

ADO

800-860 SERIE PVC PROFIL SYSTEM

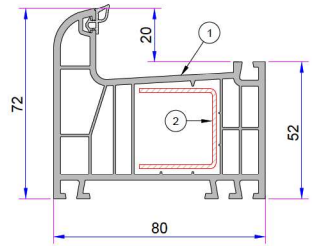

- 1. Frame Profile**
P.A.860.1000.600.0.BC.01
- 2. Reinforcement (29x30x29)**
1,2mm 34022-12002
1,5mm 34022-15002
2 mm 34022-20002

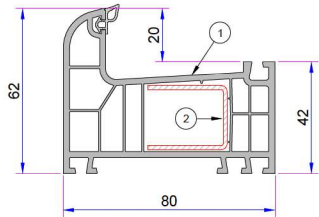

- 1. Eco Frame Profile**
P.A.860.1003.600.0.BC.01
- 2. Reinforcement (30x24x30)**
1,2mm 34022-12004
1,5mm 34022-15004
2 mm 34022-20004

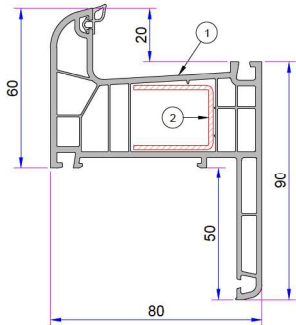

- 1. Frame Profile with Sill**
P.A.860.1200.600.0.BC.01
- 2. Reinforcement (30x24x30)**
1,2mm 34022-12004
1,5mm 34022-15004
2 mm 34022-20004

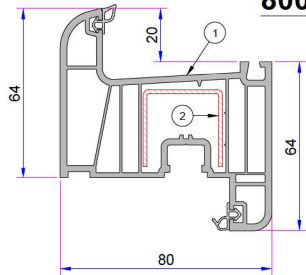

- 1. Sash Profile**
P.A.860.2000.600.0.BC.01
- 2. Reinforcement (29x30x29)**
1,2mm 34022-12002
1,5mm 34022-15002
2 mm 34022-20002

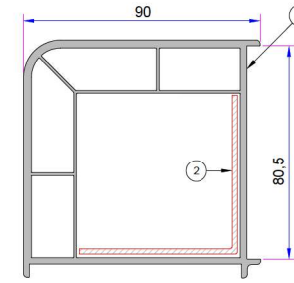
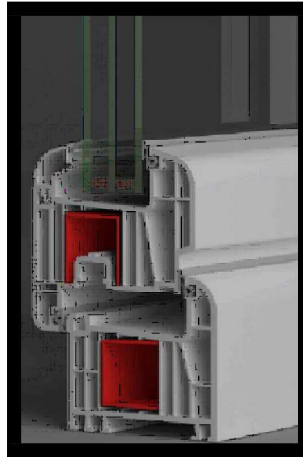

- 1. 90° Corner Profile**
P.A.080.5100.600.0.00.19
- 2. Reinforcement (60x60)**
1,2mm - 34022 - 12306
1,5mm - 34022 - 15306
2 mm - 34022 - 20306

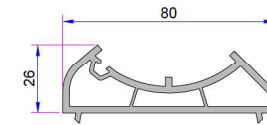

- Angled Pipe Adaptor Profile**
P.A.080.5104.600.0.00.19

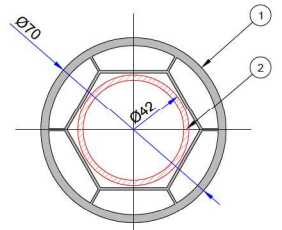

- 1. Angled Pipe Profile**
P.A.080.5106.600.0.00.19
- 2. Reinforcement (60x60)**
1,2mm - 34022 - 12502
1,5mm - 34022 - 15502
2 mm - 34022 - 20502

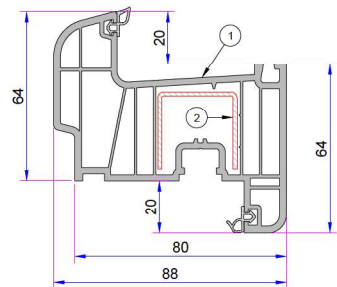

- 1. Offset Type Sash Profile**
P.A.860.2200.600.0.BC.01
- 2. Reinforcement (29x30x29)**
1,2mm 34022-12002
1,5mm 34022-15002
2 mm 34022-20002

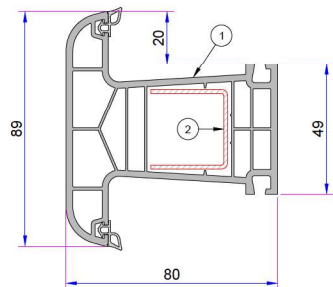

- 1. Mullion Profile**
P.A.860.3000.600.0.BC.01
- 2. Reinforcement (29x30x29)**
1,2mm 34022-12002
1,5mm 34022-15002
2 mm 34022-20002

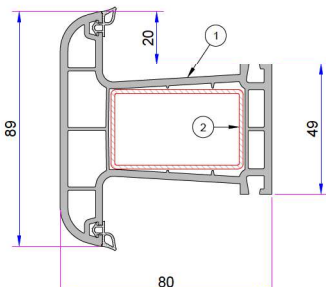

- 1. Static Mullion Profile**
P.A.800.3009.600.0.BC.01
- 2. Reinforcement (30x50)**
1,2mm 34022-12111
1,5mm 34022-15111
2 mm 34022-20111

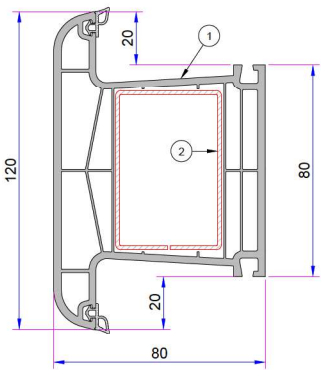

- 1. Super Static Mullion Profile**
P.A.800.3008.600.0.BC.01
- 2. Reinforcement (40x60)**
1,2mm 34022-12110
1,5mm 34022-15110
2 mm 34022-20110

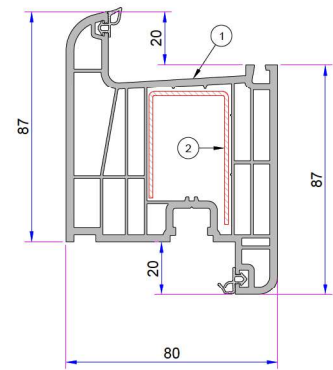

- 1. Door Sash Profile**
P.A.800.2100.600.0.BC.01
- 2. Reinforcement (40x30x50)**
1,2mm 34022-12014
1,5mm 34022-15014
2 mm 34022-20014

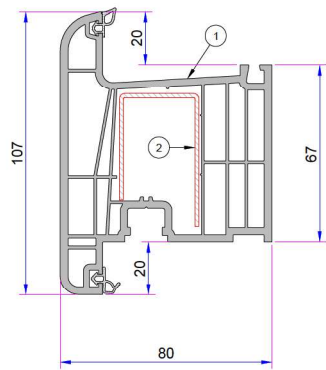

- 1. Outward Opening Door Sash Profile**
P.A.800.2101.600.0.BC.01
- 2. Reinforcement (40x30x50)**
1,2mm 34022-12014
1,5mm 34022-15014
2 mm 34022-20014

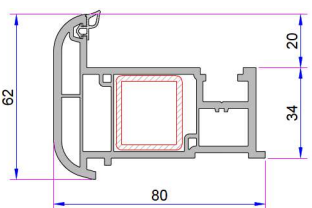

- 1. Lap Joint Profile**
P.A.800.3100.600.0.BC.19
- 2. Reinforcement (28x25)**
1,2mm 34022-12117
1,5mm 34022-15117
2 mm 34022-20117

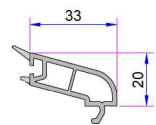

- 24mm Double Glazing Bead**
P.A.800.4200.600.0.HC

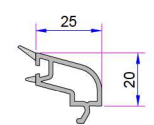

- 32mm Double Glazing Bead**
P.A.800.4500.600.0.HC

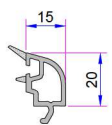

- 42 mm Double Glazing Bead**
P.A.800.4600.600.0.HC

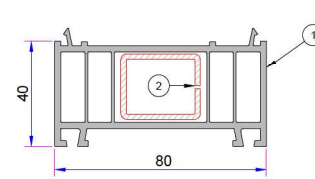

- 1. Frame Lifting Profile**
P.A.080.5300.600.0.00.19
- 2. Reinforcement (30x25)**
1,2mm - 34022 - 12119
1,5mm - 34022 - 15119
2 mm - 34022 - 20119

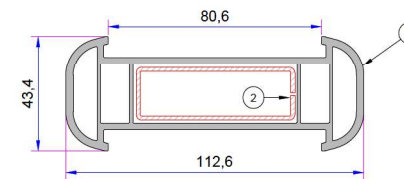

- 1. Large Coupling Profile**
P.A.080.5000.600.0.00.19
- 2. Reinforcement (60x20)**
1,2mm - 34022 - 12106
1,5mm - 34022 - 15106
2 mm - 34022 - 20106

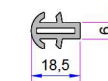

- Short Coupling Profile**
P.A.099.5003.600.0.00.19

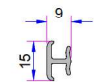

- Universal Short Coupling Profile**
P.A.099.5004.600

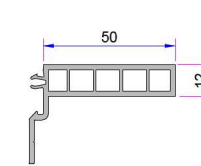

- 50mm Frame Sill Profile**
P.A.099.5524.600.0.00.19

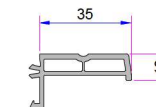

- 35mm Frame Sill Profile**
P.A.099.5523.600.0.00.19

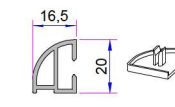

- Offset Profile**
P.A.900.6307.600.0.00.19

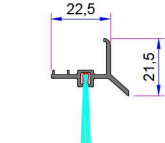

- Alm. Threshold Offset Profile**
AD16-057

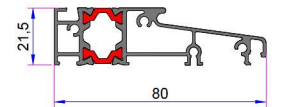

- Alm. Threshold Profile**
AD16-066

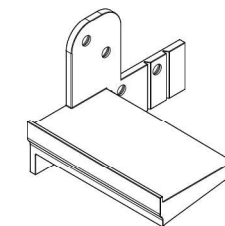

- Aluminium Threshold Wedge**
221013.0000.L - 221013.0000.R

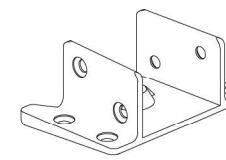

- Mullion Connector**
34007-11100

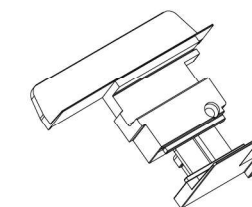

- Lap Joint Cover**
34012-10080

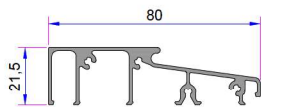

- Aluminium Threshold Profile**
AD16-003

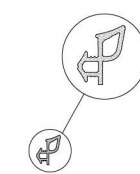

- Frame Seal**

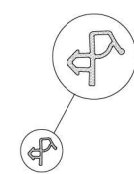

- Sash Seal**

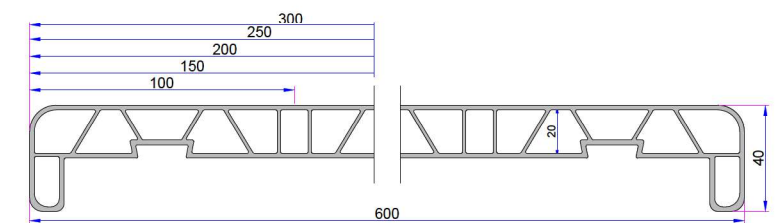

- PVC Sill Profile (600mm)**
P.DNZ.01.60.E.600.19