

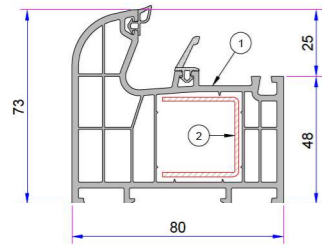

873 SERIE PVC PROFIL SYSTEM

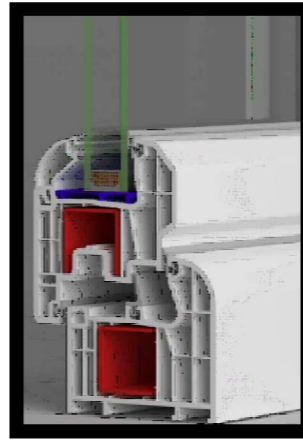

- 1. **Frame Profile**
P.A.873.1000.600.0.BC.01
- 2. **Reinforcement (29x30x29)**
1,2mm 34022-12002
1,5mm 34022-15002
2 mm 34022-20002

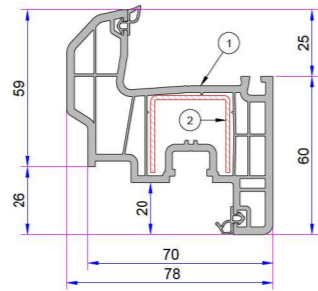

- 1. **Sash Profile**
P.A.777.2000.600.0.BC.01
- 2. **Reinforcement (29x30x29)**
1,2mm 34022-12002
1,5mm 34022-15002
2 mm 34022-20002

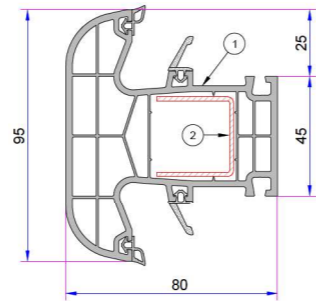

- 1. **Mullion Profile**
P.A.873.3000.600.0.BC.01
- 2. **Reinforcement (29x30x29)**
1,2mm 34022-12002
1,5mm 34022-15002
2 mm 34022-20002

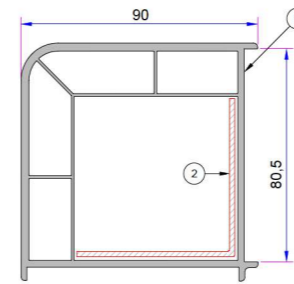

- 1. **90° Corner Profile**
P.A.080.5100.600.0.00.19
- 2. **Reinforcement (60x60)**
1,2mm - 34022 - 12306
1,5mm - 34022 - 15306
2 mm - 34022 - 20306

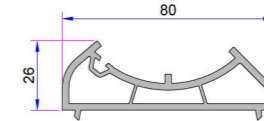

- Angled Pipe Adaptor**
P.A.080.5104.600.0.00.19

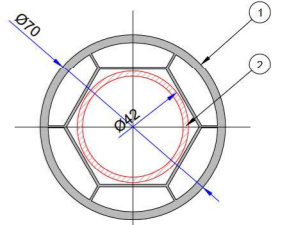

- 1. **Angled Pipe Profile**
P.A.080.5106.600.0.00.19
- 2. **Reinforcement (60x60)**
1,2mm - 34022 - 12502
1,5mm - 34022 - 15502
2 mm - 34022 - 20502

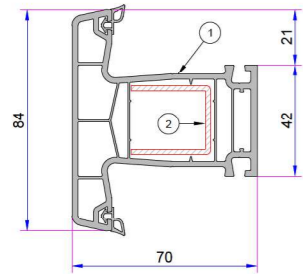

- 1. **Mullion For Door Profile**
P.A.873.3000.600.0.BC.01
- 2. **Reinforcement (30x25x30)**
1,2mm 34022-12004
1,5mm 34022-15004
2 mm 34022-20004

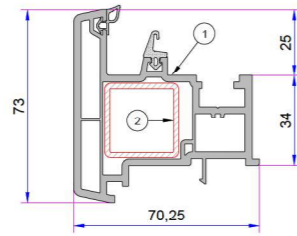

- 1. **Lap Joint Profile**
P.A.777.3100.600.0.BC.19
- 2. **Reinforcement (28x28)**
1,2mm 34022-12113
1,5mm 34022-15113
2 mm 34022-20113

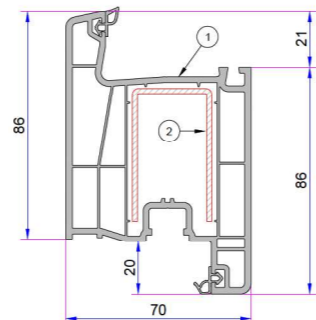

- 1. **Door Sash Profile**
P.A.750.2100.600.0.BC.01
- 2. **Reinforcement (50x30x50)**
1,2mm 34022-12013
1,5mm 34022-15013
2 mm 34022-20013

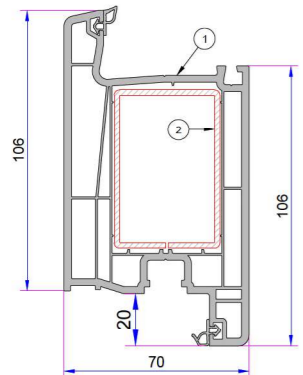

- 1. **Super Door Sash Profile**
P.A.750.2103.600.0.BC.01
- 2. **Reinforcement (40x60)**
1,2mm 34022-12110
1,5mm 34022-15110
2 mm 34022-20110

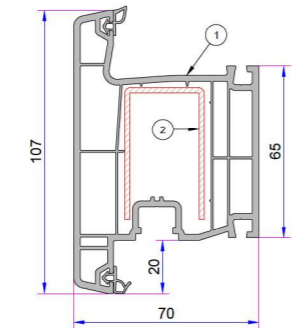

- 1. **Outward Opening Door Sash Profile**
P.A.750.2101.600.0.BC.01
- 2. **Reinforcement (50x30x50)**
1,2mm 34022-12013
1,5mm 34022-15013
2 mm 34022-20013

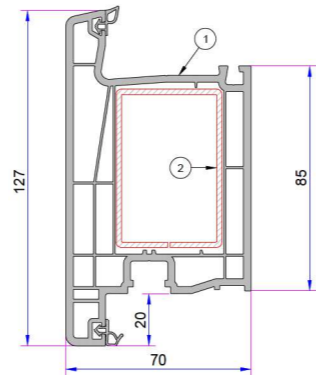

- 1. **Outward Opening Super Door Sash Profile**
P.A.752.2104.600.0.BC.01
- 2. **Reinforcement (40x60)**
1,2mm 34022-12110
1,5mm 34022-15110
2 mm 34022-20110

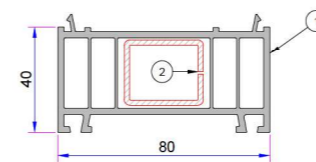

- 1. **Frame Lifting Yükseltme Profile**
P.A.080.5300.600.0.00.19
- 2. **Reinforcement (30x25)**
1,2mm - 34022 - 12119
1,5mm - 34022 - 15119
2 mm - 34022 - 20119

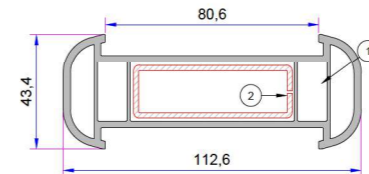

- 1. **Large Coupling Profile**
P.A.080.5000.600.0.00.19
- 2. **Reinforcement (60x20)**
1,2mm - 34022 - 12106
1,5mm - 34022 - 15106
2 mm - 34022 - 20106

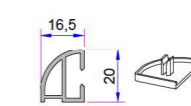

- Offset Profile**
P.A.900.6307.600.0.00.19

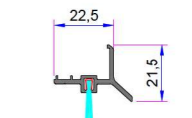

- Alm. Threshold Offset Profile**
AD16-057

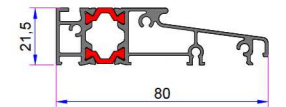

- Alm. Threshold Profile**
AD16-056

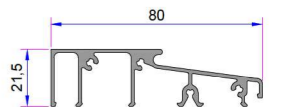

- Aluminium Threshold Profile**
AD16-003

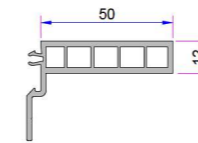

- 50mm Frame Sill Profile**
P.A.099.5524.600.0.00.19

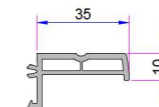

- 35mm Frame Sill Profile**
P.A.099.5523.600.0.00.19



- Universal Short Coupling Profile**
P.A.099.5004.600.0.00.19

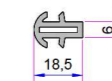

- Short Coupling Profile**
P.A.099.5003.600.0.00.19

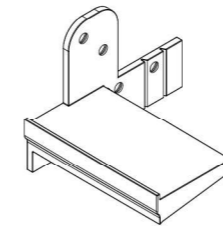

- Aluminium Threshold Wedge**
221013.0000.L - 221013.0000.R

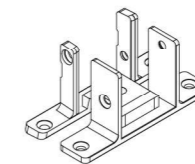

- Mullion Connector**
34007-11180

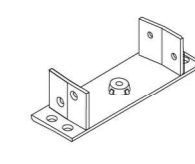

- Door Sash Connector**
34007-12150

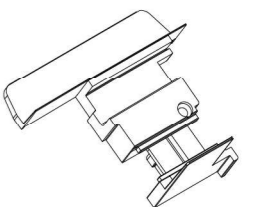

- Lap Joint Cover**
34012-10200

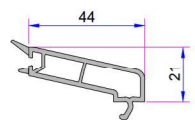

- 4 - 6 mm Single Glazing Bead**
P.A.750.4000.600.0.HC

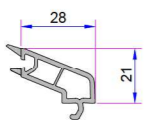

- 20 mm Double Glazing Bead**
P.A.750.4100.600.0.HC

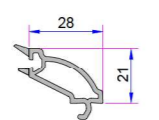

- 20 mm Double Glazing Bead**
P.A.750.4102.600.0.HC

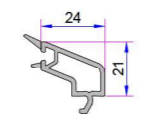

- 24 mm Double Glazing Bead**
P.A.750.4200.600.0.HC

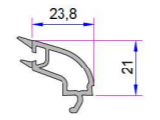

- 24 mm Double Glazing Bead**
P.A.777.4204.600.0.HC

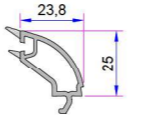

- 24 mm Double Glazing Bead**
P.A.777.4204.600.0.HC

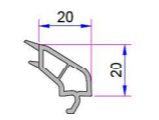

- 28 mm Double Glazing Bead**
P.A.101.4100.600.0.HC

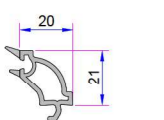

- 28 mm Double Glazing Bead**
P.A.101.4102.600.0.HC

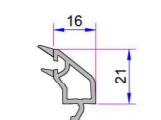

- 32 mm Triple Glazing Bead**
P.A.750.4500.600.0.HC

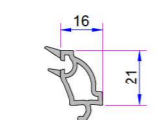

- 32 mm Triple Glazing Bead**
P.A.101.4202.600.0.HC

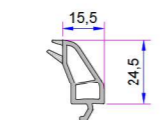

- 32 mm Triple Glazing Bead**
P.A.777.4302.600.0.HC

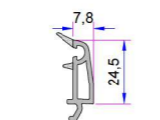

- 40 mm Triple Glazing Bead**
P.A.433.4500.600.0.HC

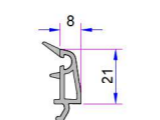

- 40 mm Triple Glazing Bead**
P.A.101.4500.600.0.HC

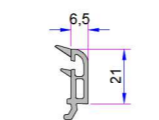

- 42 mm Triple Glazing Bead**
P.A.532.4500.600.0.HC

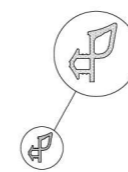

- Frame Seal**

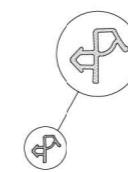

- Sash Seal**

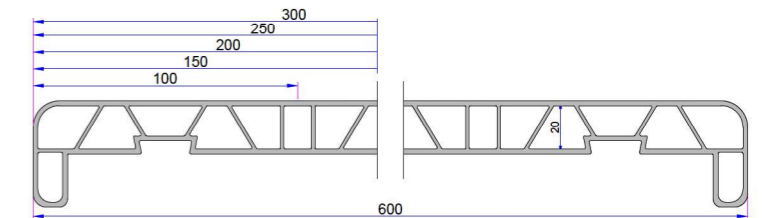

- PVC Sill Profile (600mm)**
P.DNZ.01.60.E.600.19