

ADO

777 SERIE PVC PROFILE SYSTEM

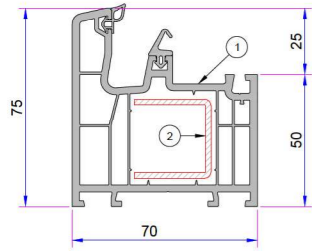

1. **Frame Profile**
P.A.777.1000.600.0.BC.01
2. **Reinforcement (29x30x29)**
1,2mm - 34022 - 12002
1,5mm - 34022 - 15002
2 mm - 34022 - 20002

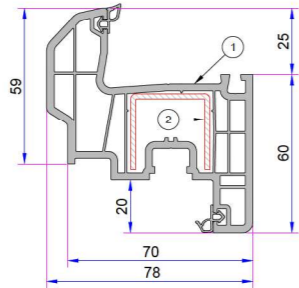

1. **Sash Profile**
P.A.777.2000.600.0.BC.01
2. **Reinforcement (29x30x29)**
1,2mm - 34022 - 12002
1,5mm - 34022 - 15002
2 mm - 34022 - 20002

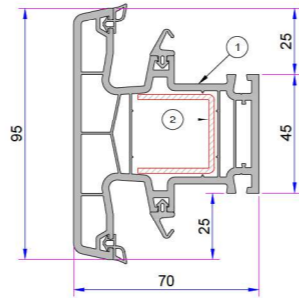

1. **Mullion Profile**
P.A.777.3000.600.0.BC.01
2. **Reinforcement (29x30x29)**
1,2mm - 34022 - 12002
1,5mm - 34022 - 15002
2 mm - 34022 - 20002

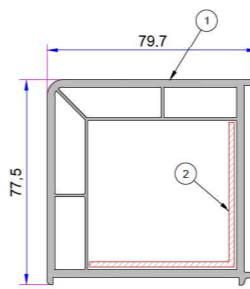
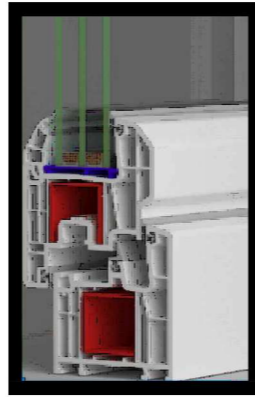

1. **90° Corner Profile**
P.A.070.5100.600.0.00.19
2. **Reinforcement (55x55)**
1,2mm - 34022 - 12305
1,5mm - 34022 - 15305
2 mm - 34022 - 20305

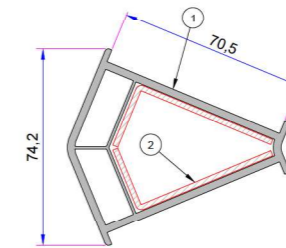

1. **135° Corner Profile**
P.A.070.5102.600.0.00.19
2. **Reinforcement (25x55)**
1,2mm - 34022 - 12303
1,5mm - 34022 - 15303
2 mm - 34022 - 20303

Angled Pipe Adaptor Profile
P.A.070.5104.600.0.00.19

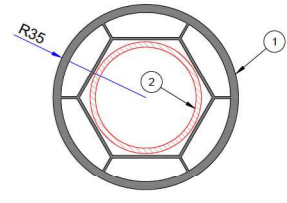

1. **Angled Pipe Profile**
P.A.070.5106.600.0.00.19
2. **Reinforcement (Ø42mm)**
1,2mm - 34022 - 12502
1,5mm - 34022 - 15502
2 mm - 34022 - 20502

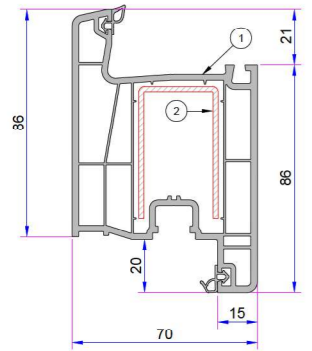

1. **Door Sash Profile**
P.A.750.2100.600.0.BC.01
2. **Reinforcement (50x30x50)**
1,2mm - 34022 - 12013
1,5mm - 34022 - 15013
2 mm - 34022 - 20013

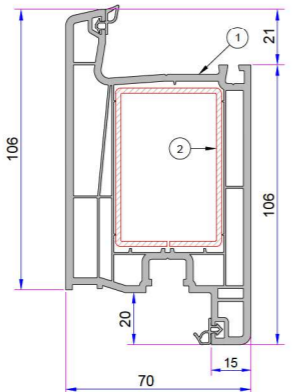

1. **Super Door Sash Profile**
P.A.750.2103.600.0.BC.01
2. **Reinforcement (60x40)**
1,2mm - 34022 - 12110
1,5mm - 34022 - 15110
2 mm - 34022 - 20110

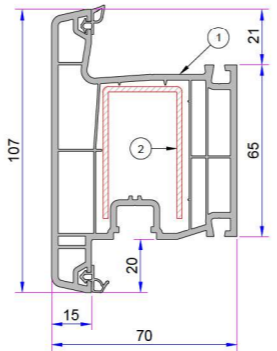

1. **Outward Opening Door Sash Profile**
P.A.750.2101.600.0.BC.01
2. **Reinforcement (50x30x50)**
1,2mm - 34022 - 12013
1,5mm - 34022 - 15013
2 mm - 34022 - 20013

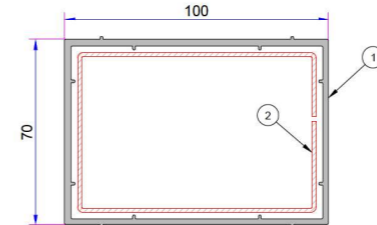

1. **Box Profile (70x100)**
P.A.070.5202.600.0.00.19
2. **Reinforcement (60x90)**
1,2mm - 34022 - 12121
1,5mm - 34022 - 15121
2 mm - 34022 - 20121

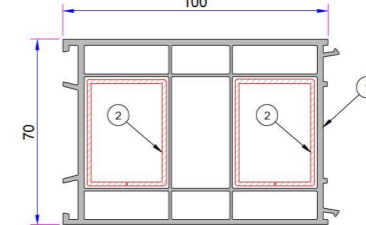

1. **100mm Frame Lifting Profile**
P.A.070.5302.600.0.00.19
2. **Reinforcement (30x40)**
1,2mm - 34022 - 12120
1,5mm - 34022 - 15120
2 mm - 34022 - 20120

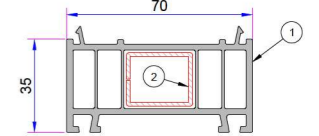

1. **35mm Frame Lifting Profile**
P.A.070.5300.600.0.00.19
2. **Reinforcement (20x25)**
1,2mm - 34022 - 12104
1,5mm - 34022 - 15104
2 mm - 34022 - 20104

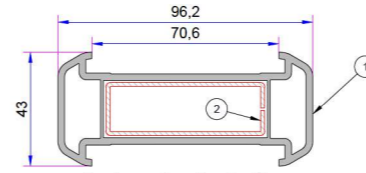

1. **Large Coupling Profile**
P.A.070.5000.600.0.00.19
2. **Reinforcement (20x60)**
1,2mm - 34022 - 12106
1,5mm - 34022 - 15106
2 mm - 34022 - 20106

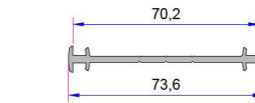

Narrow Coupling Profile
P.A.070.5001.600.0.00.19

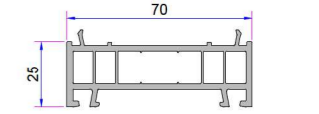

25mm Frame Lifting Profile
P.A.070.5306.600.0

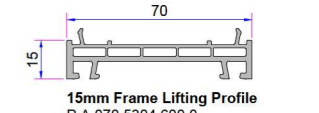

15mm Frame Lifting Profile
P.A.070.5304.600.0

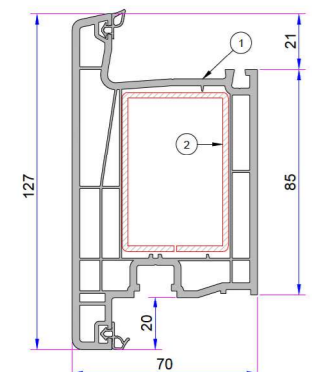

1. **Outward Opening Super Door Sash Profile**
P.A.750.2104.600.0.BC.01
2. **Reinforcement (60x40)**
1,2mm - 34022 - 12110
1,5mm - 34022 - 15110
2 mm - 34022 - 20110

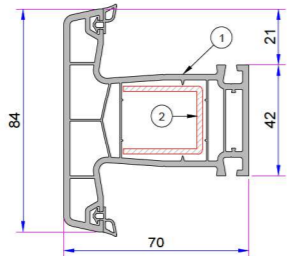

1. **Mullion Profile**
P.A.750.3000.600.0.BC.01
2. **Reinforcement (30x25x30)**
1,2mm - 34022 - 12004
1,5mm - 34022 - 15004
2 mm - 34022 - 20004

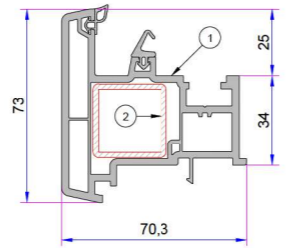

1. **Lap Joint Profile**
P.A.777.3100.600.0.BC.01
2. **Reinforcement (28x28)**
1,2mm - 34022 - 12113
1,5mm - 34022 - 15113
2 mm - 34022 - 20113

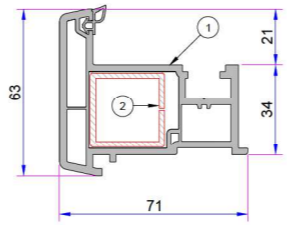

1. **Door Lap Joint Profile**
P.A.750.3100.600.0.BC.01
2. **Reinforcement (28x28)**
1,2mm - 34022 - 12113
1,5mm - 34022 - 15113
2 mm - 34022 - 20113

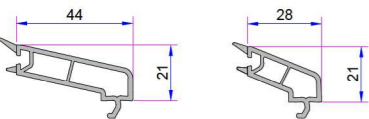

4 - 6 mm Single Glazing Bead
P.A.750.4000.600.0.HC

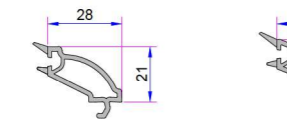

20 mm Double Glazing Bead
P.A.750.4100.600.0.HC

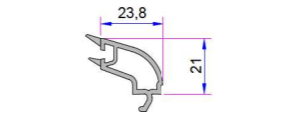

24 mm Double Glazing Bead
P.A.750.4200.600.0.HC

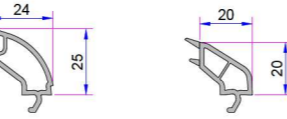

24 mm Double Glazing Bead
P.A.777.4204.600.0.HC

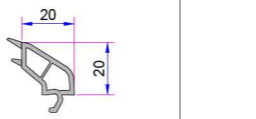

28 mm Double Glazing Bead
P.A.101.4100.600.0.HC



28 mm Double Glazing Bead
P.A.101.4102.600.0.HC

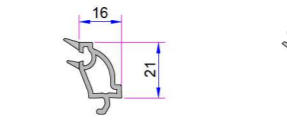

32 mm Triple Glazing Bead
P.A.101.4202.600.0.HC

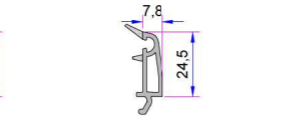

32 mm Triple Glazing Bead
P.A.777.4302.600.0.HC



40 mm Triple Glazing Bead
P.A.433.4500.600.0.HC

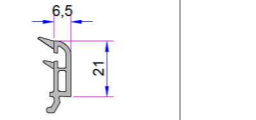

40 mm Triple Glazing Bead
P.A.101.4500.600.0.HC

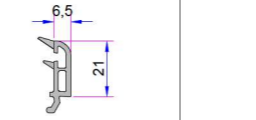

42 mm Triple Glazing Bead
P.A.532.4500.600.0.HC

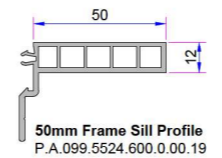

50mm Frame Sill Profile
P.A.099.5524.600.0.00.19

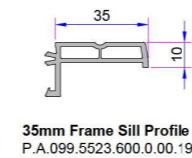

35mm Frame Sill Profile
P.A.099.5523.600.0.00.19

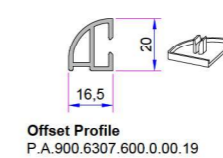

Offset Profile
P.A.900.6307.600.0.00.19

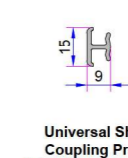

Universal Short Coupling Profile
P.A.099.5004.600.0.00.19

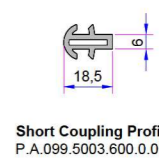

Short Coupling Profile
P.A.099.5003.600.0.00.19

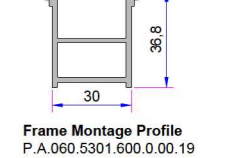

Frame Montage Profile
P.A.060.5301.600.0.00.19

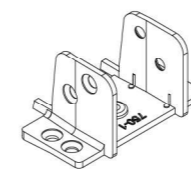

Mullion Connector
34007-12140

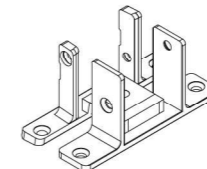

Narrow Mullion Connector
34007-11180

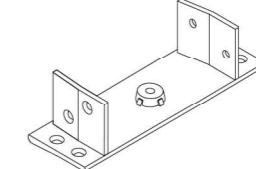

Outward Opening Door Sash Connector
34007-12150

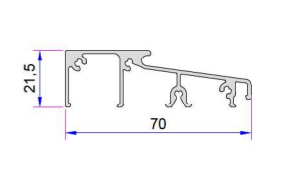

Aluminium Threshold Profile
AD16-002

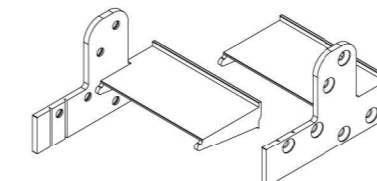

Aluminium Threshold Wedge
221013.0000.L - 221013.0000.R

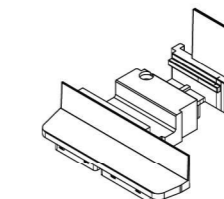

Lap Joint Cover Profile
34012-10200

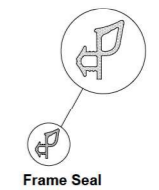

Frame Seal

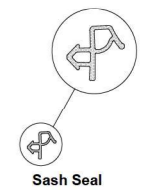

Sash Seal

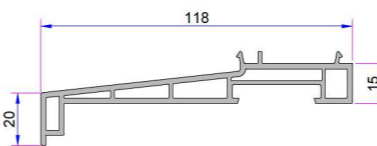

Sill Profile
P.A.058.5504.600.0.00.19

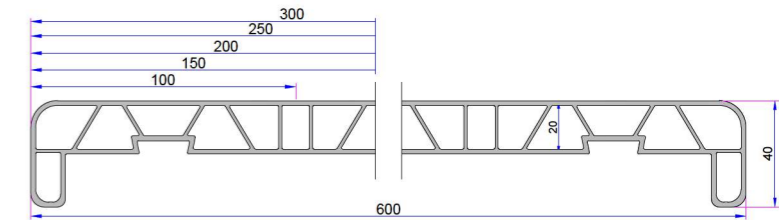

PVC Sill Profile (600mm)
P.DNZ.01.60.E.600.19